

# PURAVANKARA



**Feel Centered**

Located just 3 Kms from Indiranagar. Large premium homes

[www.Zricks.com](http://www.Zricks.com)

## Centrally located homes give you more time in life.

Work close by, shop close by, entertain close by.

Welcome to Purva Season. At a mere 3 kms from Indiranagar, this project is next door to the overwhelmingly green DRDO Township and Center for Artificial Intelligence.

Special features:

- \* 1, 2 and 3 bhk premium apartments set in a elite neighbourhood of 660 residents.
- \* A 22,000 sft. , 7-star clubhouse with all the modern amenities.
- \* Project set on 10.35 acres of pristine greenery.
- \* Very close to city's shopping hubs, entertainment zones and schools.



ZRICKS.COM



ZRICKS

# Location Map

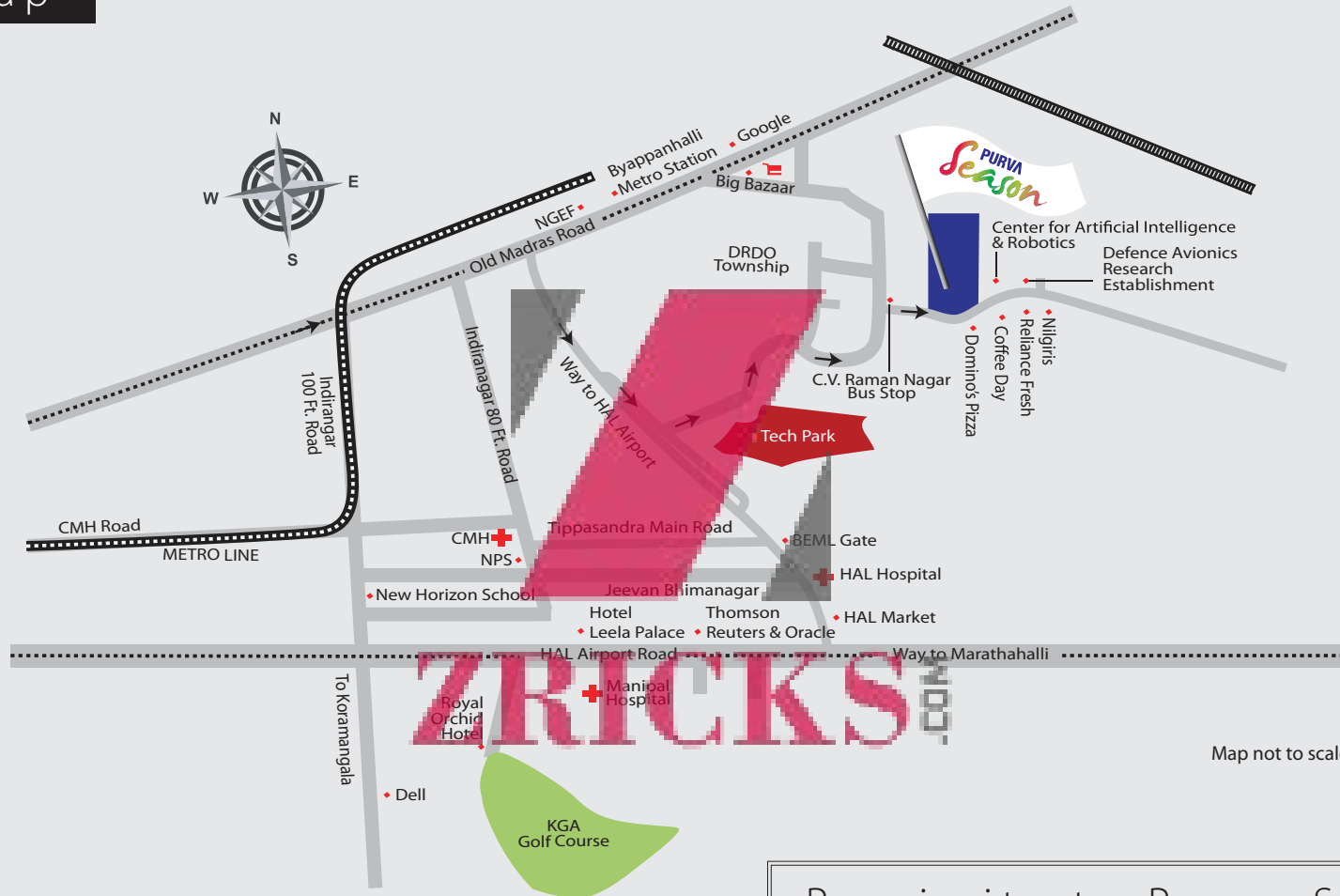

Map not to scale

## Proximity to Purva Season

Indiranagar	- 3 Kms	M.G. Road, Trinity Circle	- 6 Kms
Byappanahalli Metro Station	- 3 Kms	C.V. Raman Nagar Tech Park	- 1.5 Kms
International Airport	- 38 Kms	ITPL	- 8 Kms
Central Railway Station	- 12 Kms	HAL	- 3 Kms
K.R. Puram Railway Station	- 3 Kms	Google	- 1.5 Kms

Site address: Kaggadasapura Main Road, Opp. M.K. Retail, C.V. Raman Nagar, Bengaluru - 560 093

# Master plan



Master Plan is subject to change.

## AMENITIES:

1. Meditation/ aerobic room
2. Squash and Badminton court
3. Billiards, table tennis
4. Steam and sauna
5. Swimming pool and toddler's pool
6. Fully equipped international fitness center
7. Multipurpose hall
8. Outdoor children's play area
9. Outdoor multipurpose court
10. Provision for library

## PROJECT INCLUDES:

1. Well-lit landscaped garden
2. Water treatment plant
3. Fire protection system
4. Sewerage treatment plant
5. Organic waste converter

## IN YOUR NEIGHBOURHOOD

**Hospitals:** CMH Hospital | Sri Lakshmi Hospital | Get Well Clinic, Jeevan Bhima Nagar | Manipal Hospital

**Super Markets:** M.K.Retail | Reliance Fresh | Nilgiris | New City Super Market | 9 to 9 | Smart

**Educational Institutions:** New Horizon Public School | NPS | Kendriya Vidyalaya | Cambridge School | Blooming Kids Preschool

SCT Institute of Technology | Garden City College | New Horizon College

**Restaurants:** Dominos Pizza | Pizza Hut | Cafe Coffee Day | Delight | Zafran | Beijing Bites | Just Kolkata | Mr. Tandoorilal

**Malls & Shopping Centres:** Gopalan Mall | Big Bazaar | MegaMart

# Wing A - Block plan

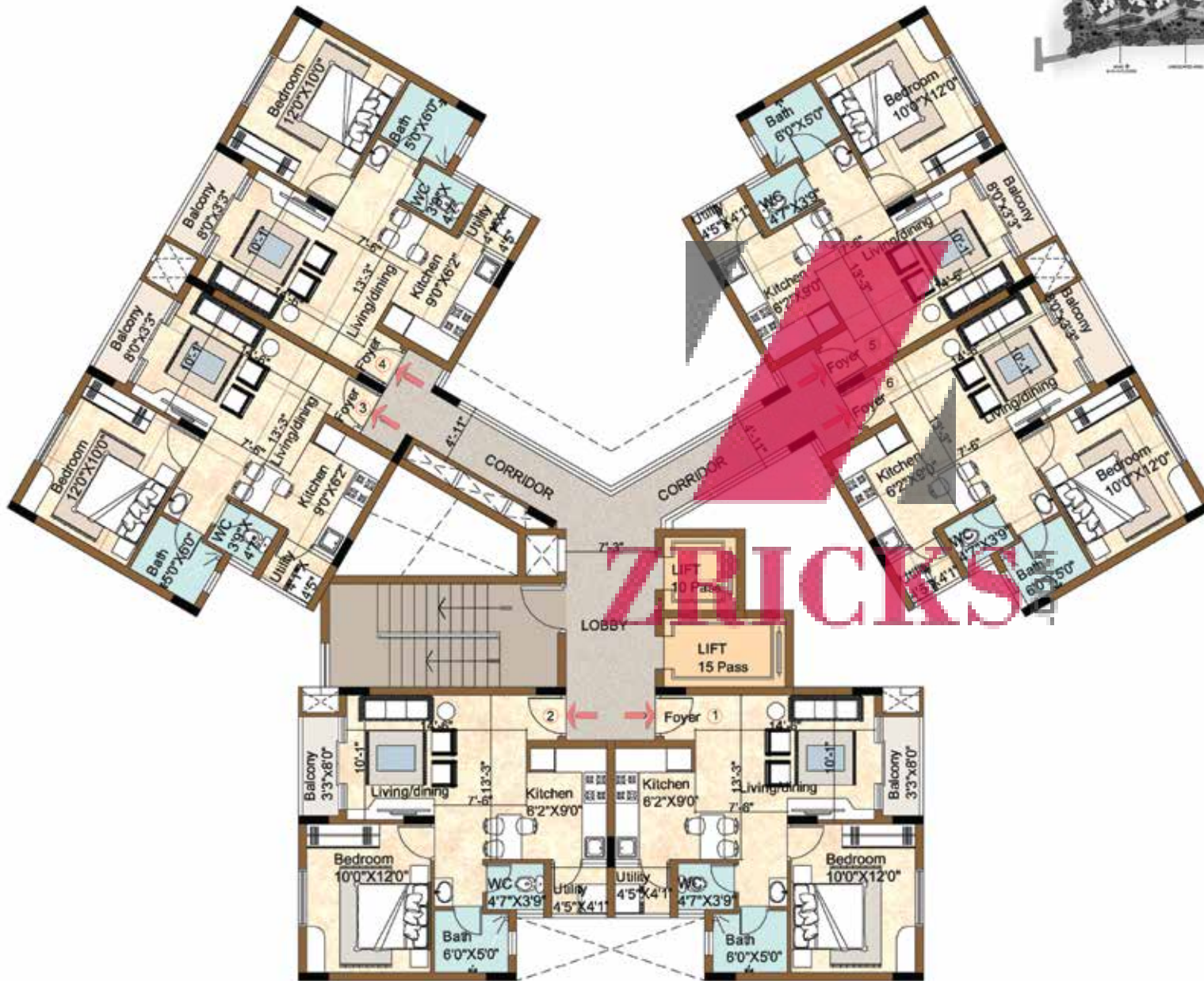
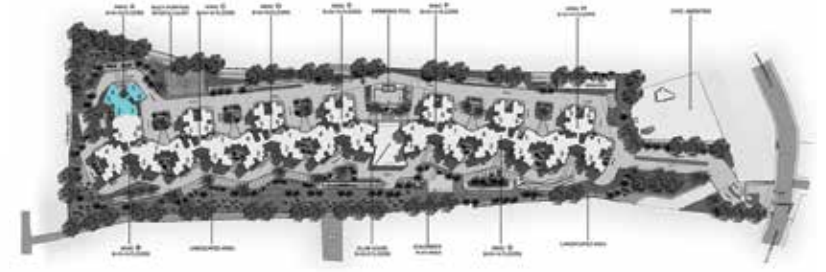

## Series 1 to 6 (1B + 1T)

1 BHK - 705 sq. ft.

- 101 to 1001
- 102 to 1002
- 103 to 1003
- 104 to 1004
- 105 to 1005
- 106 to 1006

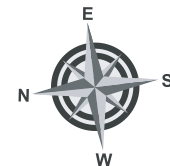

# Wing B - Block plan

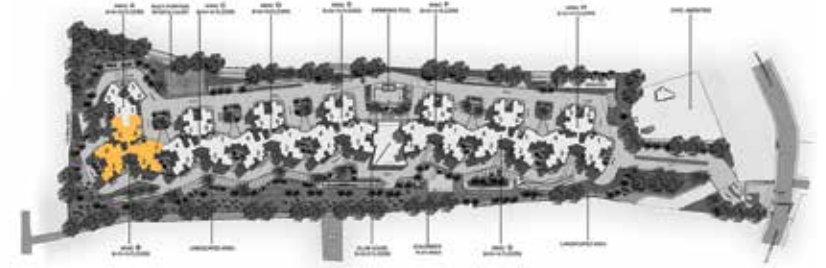

<b>Series 1 (2B+2T)</b>
2 BHK - 1392 sq. ft.
101 to 1401
<b>Series 2 (3B+3T)</b>
3 BHK - 1788 sq. ft.
102 to 1402
<b>Series 3 (3B+3T+SR)</b>
3 BHK - 1980 sq. ft.
103 to 1403
<b>Series 4 (3B+3T)</b>
3 BHK - 1659 sq. ft.
104 to 1404
<b>Series 5 &amp; 6 (3B+3T)</b>
3 BHK - 1825 sq. ft.
105 to 1405
106 to 1406

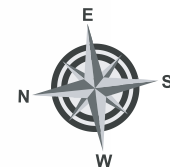

# Wing C - Block plan

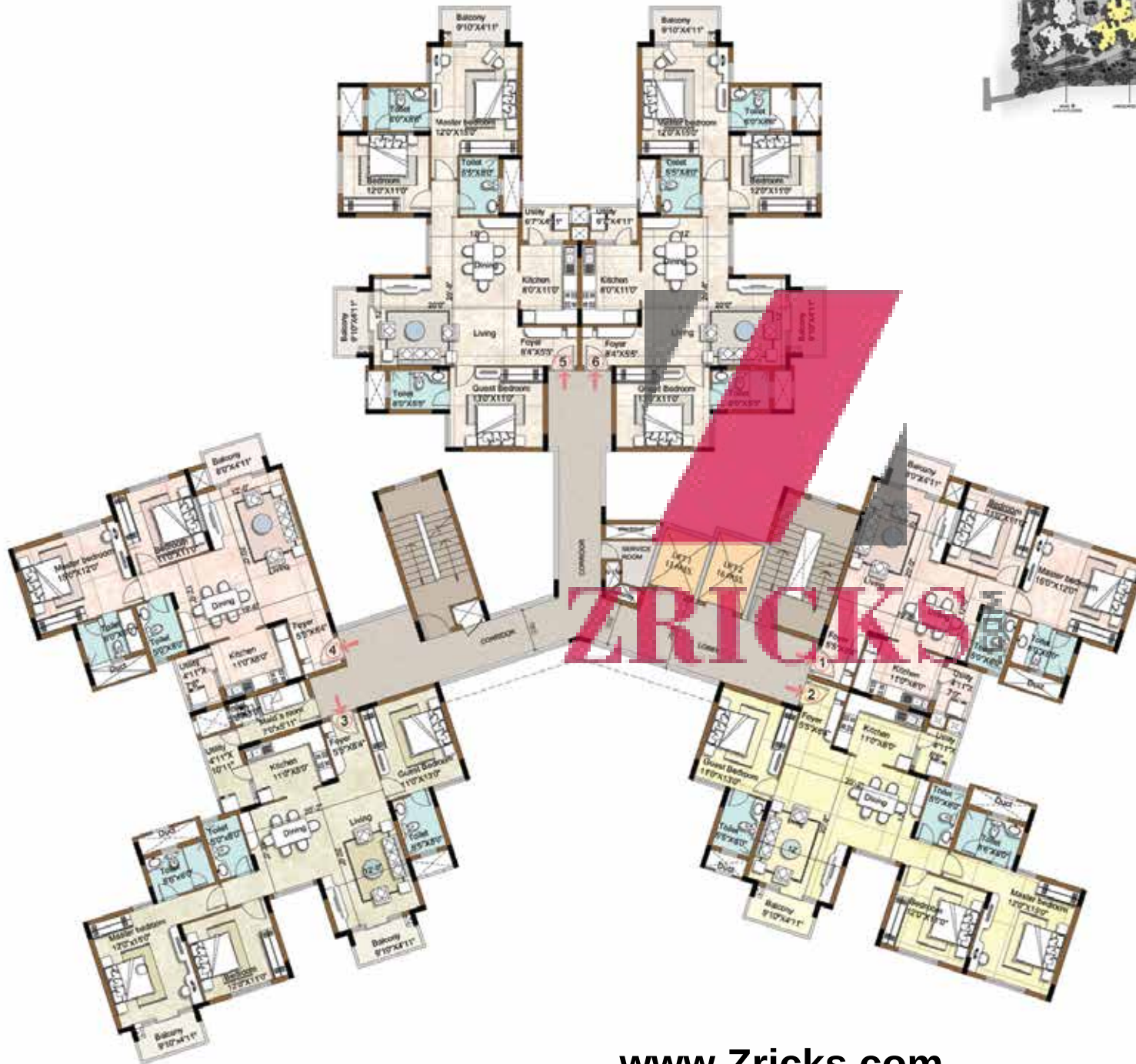
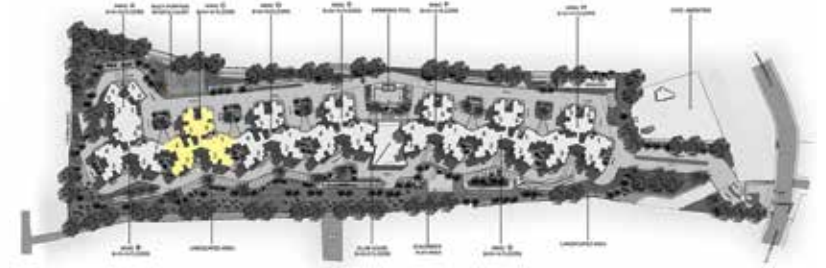

<b>Series 1 &amp; 4 (2B+2T)</b>
2 BHK - 1392 sq. ft.
101 to 1401
104 to 1404
<b>Series 2 (3B+3T)</b>
3 BHK - 1788 sq. ft.
102 to 1402
<b>Series 3 (3B+3T+SR)</b>
3 BHK - 1980 sq. ft.
103 to 1403
<b>Series 5 &amp; 6 (3B+3T)</b>
3 BHK - 1836 sq. ft.
105 to 1405
106 to 1406

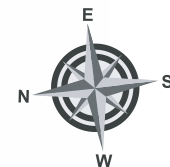



# Wing D - Block plan

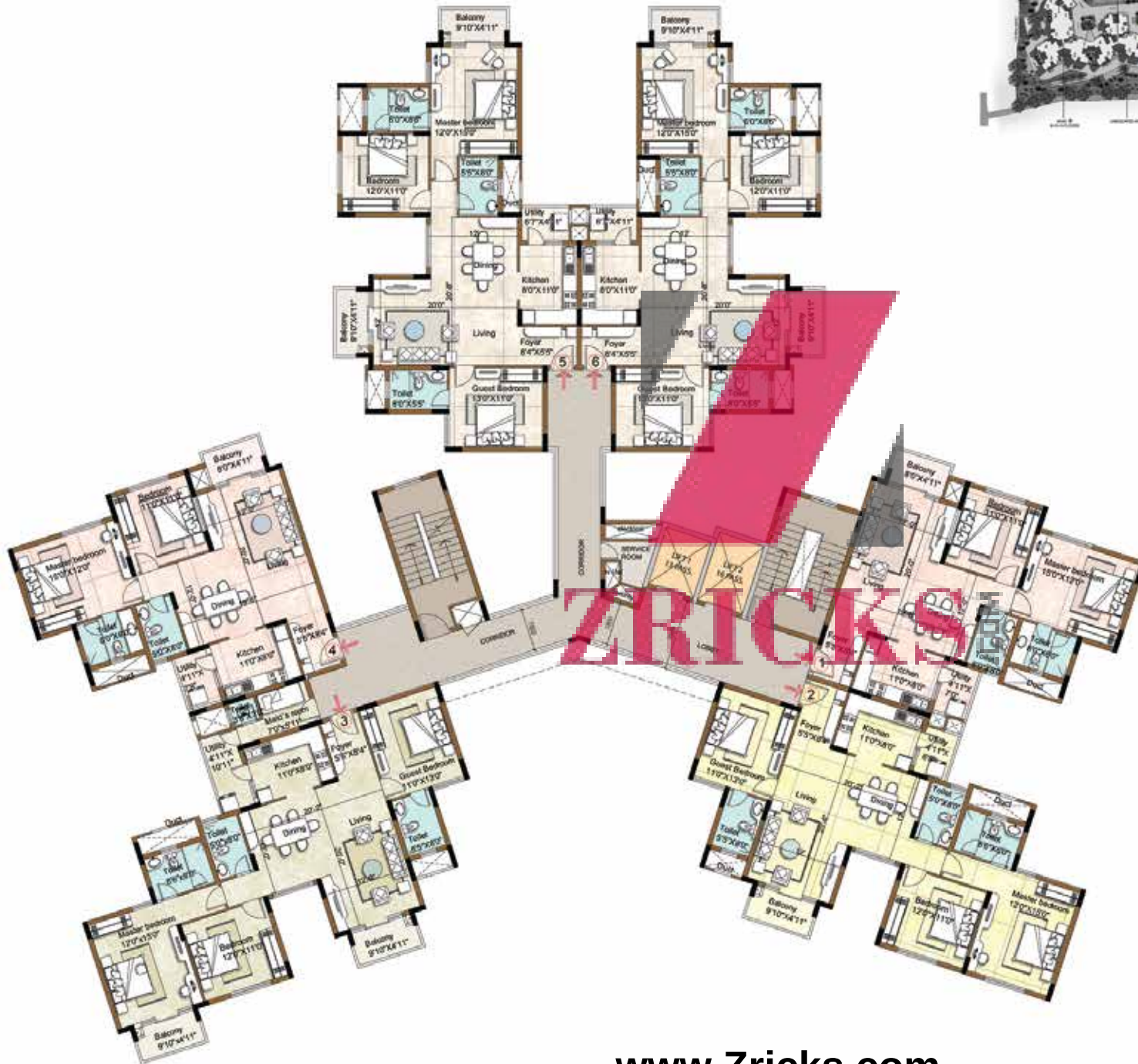

## Series 1 & 4 (2B+2T)

2 BHK - 1392 sq. ft.

101 to 1501

104 to 1504

## Series 2 (3B+3T)

3 BHK - 1788 sq. ft.

102 to 1502

## Series 3 (3B+3T+SR)

3 BHK - 1980 sq. ft.

103 to 1503

## Series 5 & 6 (3B+3T)

3 BHK - 1836 sq. ft.

105 to 1505

106 to 1506

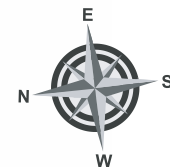

# Unit Plans

## 3 BHK

Super Builtup Area - 1836 sq. ft.



## 3 BHK

Super Builtup Area - 1825 sq. ft.



## 3 BHK + Servant room

Super Builtup Area - 1980 sq. ft.



## 3 BHK

Super Builtup Area - 1788 sq. ft.



## 2 BHK

Super Builtup Area - 1392 sq. ft.



## 1 BHK

Super Builtup Area - 705 sq. ft.



# Project Specifications

## Structure:

- RCC framed structure

## Lobby & Staircase:

- Elegant ground floor lobby with marble/granite flooring
- Upper floor lobbies & corridors with vitrified tiles

## Apartment Flooring:

- Large format vitrified tiles in living, dining, bedrooms, passages leading to bedrooms
- Anti-skid tiles in balconies

## Kitchen & Utility:

- Vitrified tile flooring in kitchen
- Full height vitrified tile dado upto roof on all walls
- Highly polished granite for kitchen counter top
- Frankie or equivalent brand double bowl, single drain stainless steel sink in 2 & 3 BHK apt. & single bowl, single drain stainless steel sink for 1 BHK with premium quality (Grohe/Kohler/Roca or equivalent) hot and cold basin mixer
- Provision for water purifier above the drain board
- Vitrified tile flooring in utility area
- Provision for washing machine in utility

## Bathrooms:

- Anti skid/matt ceramic designer tile flooring
- Colored glazed designer tiles up to the false ceiling
- Master Bathroom - Granite/marble counter-top wash basin with hot & cold water mixer, shower area with diverter and rain shower, shower panel & openable shower partition
- Other Bathrooms - Granite/marble counter-top wash basin, shower area with rain shower and diverter & wall mounted EWC with premium quality CP fittings & sanitary fixtures

- All bathrooms are fitted with premium quality (Grohe/Kohler/Roca or equivalent brand) CP fittings and premium quality (Kohler/Duravit/Roca or equivalent brand) sanitary fixtures

## Doors:

- Main door – teak wood frame and paneled door with melamine polished on both sides with good quality hardware and security eye
- Bedroom doors – engineered door and frame with solid wood core with good quality hardware and thumb turn lock
- Bathroom doors – teak wood frame with solid core flush door with P. U laminated surface (inside) & melamine polish (outside)
- Balconies for living & dining – Glazed French windows with heavy gauged UPVC frames with sliding shutters with mosquito mesh for windows
- Utility door-glazed door and window with heavy gauged UPVC frames with hinged shutters

## Windows:

- Heavy gauged UPVC frames with glazed, sliding/hinged shutters with mosquito mesh and M. S. Grills

## Ventilators:

- Heavy gauged, UPVC with glazed, louvered/hinged/fix ventilators
- Provision for exhaust fan

## Painting:

- Acrylic based paint & textured surfaces in selective places as per design for exterior fascia of the building
- Interior walls are painted in acrylic emulsion

## Ceilings:

- Cornices in living, dining, foyer & in passage areas

## Balcony Railings:

- Stainless steel railings with toughened glass

## Electrical:

- All electrical wiring is concealed with premium quality PVC conduits
- Adequate power outlets for lights, fans, exhaust-fans, call-bell, television and AC points are provided in all bedrooms, living and dining area
- 5 KW power will be provided for 3 BHK, 3 KW power for 2 BHK & 2 KW power for 1 BHK.
- Telephone & Internet connectivity in living area and provision in all the bedrooms
- Television outlet in and provision for cable TV connection in living area and in all bedrooms

## Elevators:

- Automatic passenger and service lifts are provided in every block with intercom facility connected to security cabin

## DG Power:

- Back-up for common area lighting, pumps and lifts.
- 3 KVA of D.G. power backup is provided for 3 BHK, 2 KVA for 2 BHK & 1 KVA for 1 BHK

## Security System & Intra Communication system:

- Integrated security system for every apartment
- Gas leak detector in kitchen.
- Peripheral vigilance through CCTV/cameras
- Intra-communication facility from apartment to apartment (cabling & EPABX only) and to security cabin within the complex



## OTHER PROJECTS ACROSS INDIA

### BANGALORE PROJECTS

**Purva Highland**

Off Kanakapura Road,  
Bangalore

**Purva Venezia**

Yelahanka,  
Bangalore

**Purva Skywood**

Off Sarjapur Road,  
Bangalore

**Purva Atria**

RMV IIInd Stage,  
Bangalore

**Purva Midtown Residences**

Off Old Madras Road,  
Bangalore

**Purva Platina**

RMV IIInd Stage,  
Bangalore

**Purva Whitehall**

On Sarjapur Main Road,  
Bangalore

**Purva Sunflower**

At Rajajinagar  
Bangalore

### KOCHI PROJECTS

**Purva Oceana**

Marine Drive,  
Kochi

**Purva Eternity**

Kakkanad,  
Kochi

**Purva GrandBay**

Marine Drive,  
Kochi

### CHENNAI & COIMBATORE PROJECTS

**Purva Swanlake**

OMR,  
Chennai

**Purva Windermere**

Pallikaranai,  
Chennai

**Purva Bluemont**

Singanallur, Trichy Road,  
Coimbatore

This project is financed by ICICI Bank Ltd.

## PURAVANKARA

Puravankara Projects Limited

Call: +91 80 44 55 55 55

[www.puravankara.com](http://www.puravankara.com)

**BANGALORE**

Corporate Office:  
130/1, Ulsoor Road,  
Bangalore - 560 042  
Ph: +91 80 44 55 55 55

[sales@puravankara.com](mailto:sales@puravankara.com)

**CHENNAI**

No.7, LVR Center, Ground Floor,  
Seshadri Road, Alwarpet  
Chennai - 600 018  
Ph: +91 44 44 55 55 55

[chennai@puravankara.com](mailto:chennai@puravankara.com)

**COIMBATORE**

No. 2247/48, Trichy Road,  
Singanallur,  
Coimbatore - 641 005  
Ph: +91 422 44 55 55 55

[coimbatore@puravankara.com](mailto:coimbatore@puravankara.com)

**KOCHI**

G-261, Panampilly Avenue,  
Kochi - 682 036  
Ph: +91 484 44 55 55 55

[saleskochi@puravankara.com](mailto:saleskochi@puravankara.com)

**DUBAI**

Opp. Imperial Suites,  
Rolla Road, Bur Dubai,  
Dubai, UAE  
Ph: +971 43 59 5818

[dubai@puravankara.com](mailto:dubai@puravankara.com)

**KINGDOM OF SAUDI ARABIA**

Unit 28, Al Rajhi Bank  
Building, King Khalid Street,  
8th Cross, Al Khobar,  
Dammam, KSA  
Ph: +966 38946459

[ksa@puravankara.com](mailto:ksa@puravankara.com)